

315-508

Honeywell Bluetooth USB Dongle is an elegant Bluetooth Low Energy (BLE) product that is used for seamlessly interfacing with the Morley STX and SMX fire panel models.

The Honeywell Bluetooth Dongle (HONBLEKIT2) is a plug and play module that enables wireless communication between the panel and the Honeywell SmartConfig™ mobile application for simple, smart and secure commissioning and maintenance operations.

The HONBLEKIT2 is compatible with SmartConfig version 2.0.0.0 onwards.

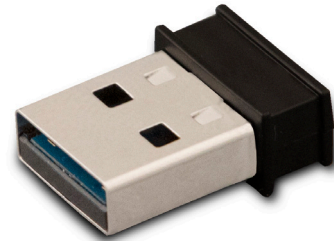

Honeywell Bluetooth Dongle (HONBLEKIT2)

Honeywell Bluetooth Dongle Specification:

CONTAINS BLUETOOTH 4.0 QUALIFIED SINGLE-MODE MODULE	
VBUS	-0.3 to 6.5 V
Operating Temperature Range	-40 to +85°C
TX current consumption (radio only, 0dBm)	12.1 mA
RX current consumption (Radio only)	33 mA
TX output power	44 mA
Approvals/ Certifications	WPC, FCC

FCC Statement:

Contains FCC ID: QOQBLED112

This HONBLEKIT2 complies with part 15 of the FCC Rules.

Operation is subject to the following two conditions:

- This device may not cause harmful interference
- This device must accept any interference received

CAUTION: Changes or modifications not expressly approved by the manufacturer could void the authority of the user to operate the equipment.

FEATURES:

Following are the features of Honeywell wireless commissioning:

- Provides seamless wireless low power Bluetooth Connectivity to Morley STX and SMX fire panel models
- Eases the panel commissioning and maintenance operations through Honeywell SmartConfig™ Mobile app
- Enables productivity through a simple interface
- Eliminates the need to carry laptops, cables and so on to the site for configuration

How to connect the Honeywell Bluetooth USB Dongle to the fire panel?

1. Open the fire panel's front door.
2. Look for the "USB 1" on the top behind the display board.
3. Plug the USB dongle into the "USB 1" port.

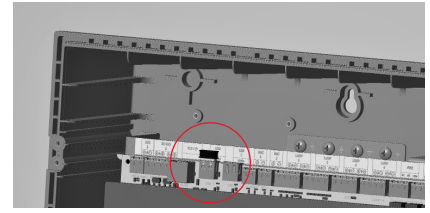
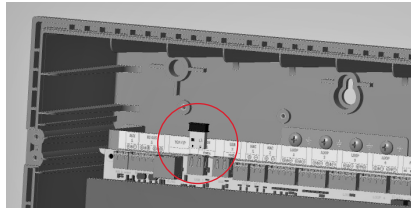

How to connect via Bluetooth to program the fire panel?



1 Launch the Honeywell Morley-IAS SmartConfig™ mobile application.



2 Establish a Bluetooth connectivity between mobile application and Fire Alarm Control panel.

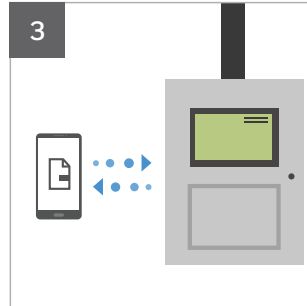

3 Configure the Fire Alarm Control Panel using™ Quickwizard.



4 Voila! The Fire Alarm Control Panel is configured.

1. Ensure that the Honeywell Bluetooth USB Dongle is connected to the fire panel.
2. On the panel, tap **Commissioning** from the Main Menu.
3. Tap next to **Configuration via Bluetooth**.
4. On the mobile, switch-on the Bluetooth and discover, select the **HONBLEKIT2** connection.
5. Enter the pass-code that appears on the panel screen into your mobile device.
6. The Bluetooth icon gets activated on the panel screen as soon as the panel is paired with the mobile device.
7. Now you can send the configuration from mobile to the panel or read from the panel, as required.

For more details on programming the fire panel via Bluetooth, refer to one or more of the following resources as required:

1. FAQ from within the SmartConfig™ mobile app.
2. SmartConfig™ PC Application User's Guide (NS-MS-0020)
3. STX SMX Programming Guide (NS-MN-0017)

Product Line Information

315-508: BLE Dongle for Wireless Commissioning

For more information

www.morley-ias.co.uk

Honeywell Building Technologies ASEAN

Level 25, UOA Corp Tower B, Avenue 10
The Vertical, Bangsar South City
59200, Kuala Lumpur, Malaysia
Email: Buildings.ASEAN@Honeywell.com

Honeywell Building Technologies India

Unitech Trade Centre, 5th Floor
Sector – 43, Block C, Sushant Lok Phase – 1
Gurgaon – 122002, Haryana, India
Email: HoneywellSecurity&Fire@Honeywell.com
Toll Free: 1-800-103-0339
www.honeywell.com

Honeywell Building Technologies META

Emaar Business Park, Building 2, 2nd Floor
Sheikh Zayed Road
P.O.Box 232362, Dubai, U.A.E.
Phone: +971 4 4505 847